



3" AND 5" DIAL BIMETAL THERMOMETER

MODEL BR3 AND BR5



Model BR3
3" Dial Bi-Metal Thermometer

FEATURES:

- All Stainless Steel Construction
- 3" (75mm) and 5" (127mm) dial size
- Glass Lens
- Anti-Parallax Dial
- Vibration resistant design for reduced needle flutter
- Fast Response
- Hermetically sealed IP68
- Accuracy: $\pm 1\%$ Full Scale
- Welded Stem

APPLICATIONS:

- Heating and Air Conditioning
- Industrial Wastewater
- Accurate Temperature Measurements

SPECIFICATIONS:

- Dial: 3" (75mm) and 5" (127mm)
- Aluminum with black markings, anti-parallax
- Case, Ring and Stem AISI 304 SS
- Recalibrator Screw Standard
- Lens: Glass, hermetically sealed
- Connection: 1/2" NPT standard
- Movement: Bi-metallic coil
- Pointer: Aluminum, painted black
- Maximum Operating Pressure: 125 PSI (861 kPa)
- Operating Temperature: 75% of full scale value (recommended maximum)
- Ambient Temperature: -58 °F to 248 °F (-50 °C to 120 °C)
- Accuracy: $\pm 1\%$ of full scale
- Enclosure Rating: IP68

*Options Available Upon Request:

- Safety Glass
- Silicone Fill

ORDERING GUIDE

STEM LENGTH*	PART NUMBER		CODE	RANGE
	3" DIAL	5" DIAL		
2.5"	BR3-2	BR5-2	TA	-40/120 F & C
4"	BR3-4	BR5-4	TB	-40/160 F & C
6"	BR3-6	BR5-6	TE	0/150 F & C
9"	BR3-9	BR5-9	TG	0/200 F & C
12"	BR3-12	BR5-12	TJ	20/240 F & C
15"	BR3-15	BR5-15	TI	0/250 F & C
18"	BR3-18	BR5-18	TM	50/300 F & C
24"	BR3-24	BR5-24	TP	50/400 F & C
			TR	50/550 F & C
			TS	150/750 F & C
			TT	200/1000 F & C

3" AND 5" DIAL BIMETAL THERMOMETER

DIMENSIONAL DRAWING

All dimensions are in inches (mm)

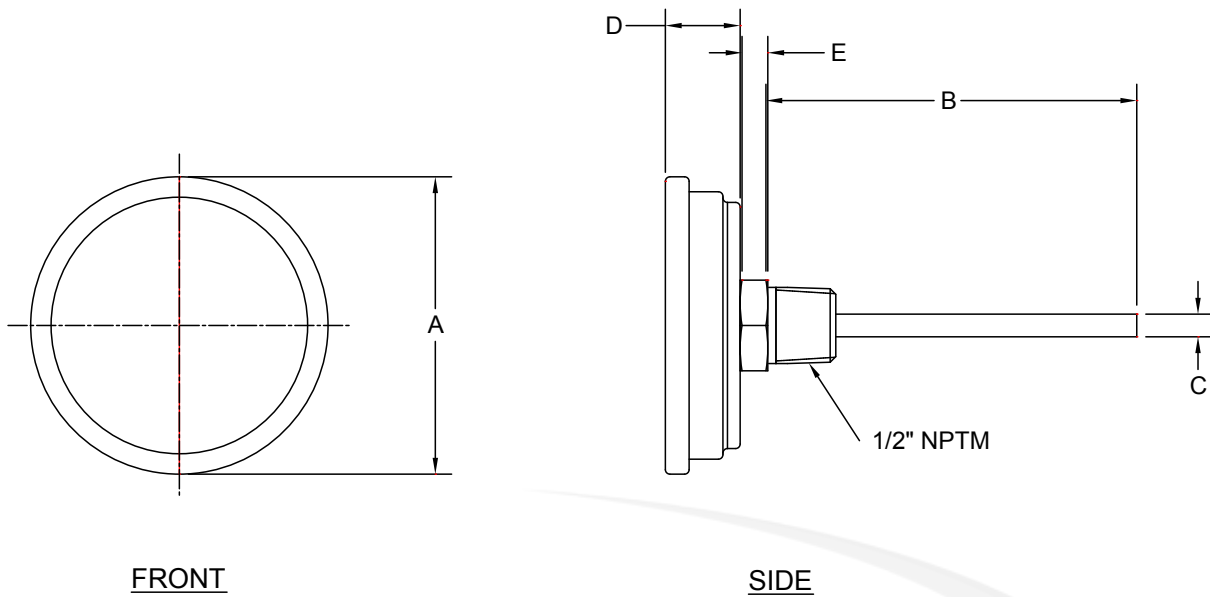

BR3-4-TG-C
3" BIMETAL THERMOMETER
1/2" NPT, 0-100 C
BACK, 4" STEM

		A	B	C	D	E
3" DIAL	IN.	3.18"	STEM LENGTH	.25"	.60"	.38"
	MM	80.78	STEM LENGTH	6.45	15.24	9.76
5" DIAL	IN.	5.13"	STEM LENGTH	.25"	.67"	.38"
	MM	130.87	STEM LENGTH	6.45	16.95	9.76

All specifications are for reference purposes only. In the interests of continuous product improvement, all specifications are subject to change without notice. Please contact Blue Ribbon Corporation for assistance with your application.



© 2015 Blue Ribbon Corp. | 2770 Long Rd, Grand Island, NY 14072 USA

Order from: **C A Briggs Company**; 622 Mary Street; Suite 101 - Warminster, PA 18974
Phone: 267-673-8117 - Fax: 267-673-8118; E-Mail: Sales@cabriggs.com - www.cabriggs.com

BIMETAL THERMOMETER ADJUSTABLE ANGLE TYPE

MODEL BR3A AND BR5A



Model BR3A and BR5A
Bi-Metal Thermometer Adjustable Angle Type

FEATURES:

- All Stainless Steel Construction
- Adjustable Angle Connection
- 3" (75mm) and 5" (127mm) dial size
- Glass Lens
- Anti-Parallax Dial
- Vibration resistant design for reduced needle flutter
- Fast Response
- Hermetically sealed IP68
- Accuracy: $\pm 1\%$ Full Scale
- Welded Stem

APPLICATIONS:

- Heating and Air Conditioning
- Industrial
- Wastewater

SPECIFICATIONS:

- Dial: 3" (75mm) and 5" (127mm)
- Aluminum with black markings, anti-parallax
- Case, Ring and Stem AISI 304 SS
- Recalibrator Screw Standard
- Lens: Glass, hermetically sealed
- Connection: $\frac{1}{2}$ " NPT standard
- Pointer: Aluminum, painted black
- Maximum Operating Pressure: 125 PSI (861 kPa)
- Operating Temperature: 75% of full scale (recommended)
- Ambient Temperature: -58 °F to 248 °F (-50 °C to 120 °C)
- Accuracy: $\pm 1\%$ of full scale
- Enclosure Rating: IP68

BIMETAL THERMOMETER ADJUSTABLE ANGLE TYPE

DIMENSIONAL DRAWING

All dimensions are in inches (mm)

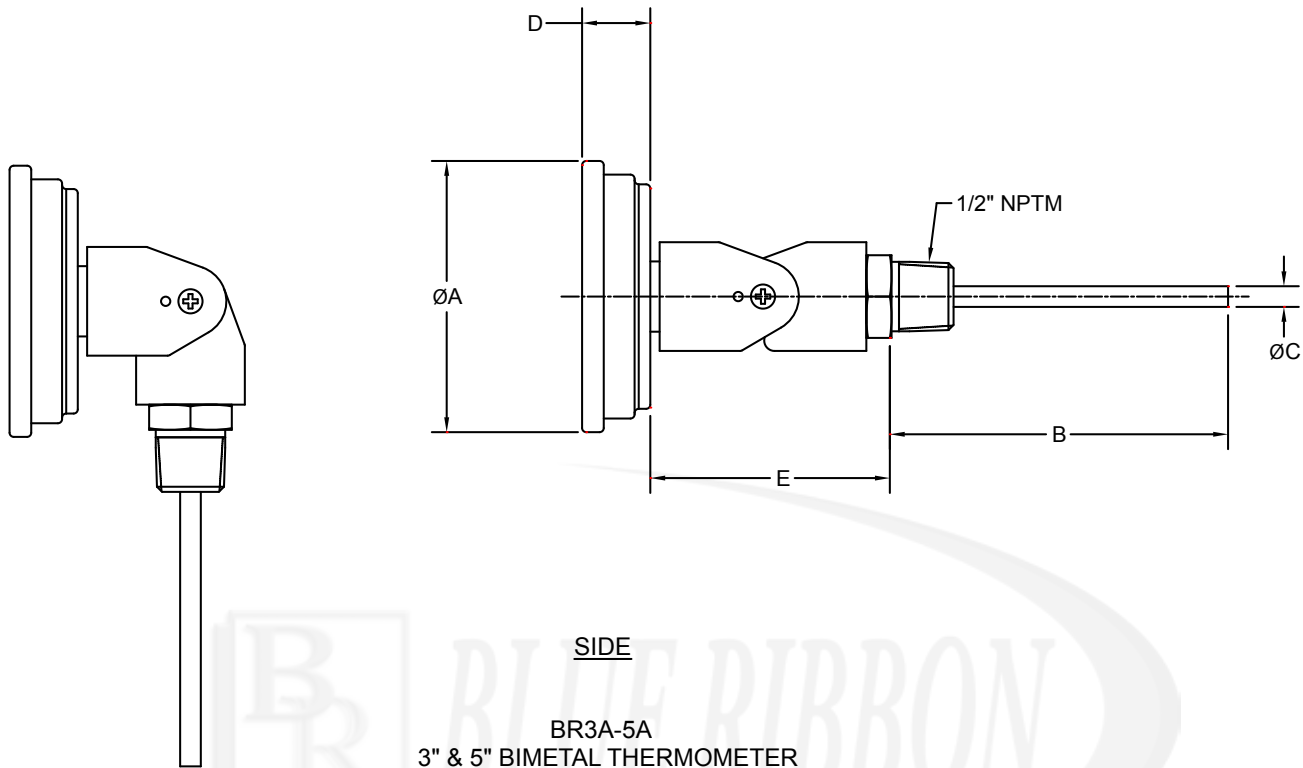

ORDERING GUIDE

		A	B	C	D	E
3" DIAL	IN.	3.18"	STEM LGTH	.25"	.60"	.38"
	MM	80.78	STEM LGTH	6.45	15.24	9.76
5" DIAL	IN.	5.13"	STEM LGTH	.25"	.67"	.38"
	MM	130.87	STEM LGTH	6.45	16.95	9.76

STEM LENGTH*	PART NUMBER		CODE	RANGE
	3" DIAL	5" DIAL		
2.5"	BR3A-2	BR5A-2	TA	-40/120 F & C
4"	BR3A-4	BR5A-4	TB	-40/160 F & C
6"	BR3A-6	BR5A-6	TE	0/150 F & C
9"	BR3A-9	BR5A-9	TG	0/200 F & C
12"	BR3A-12	BR5A-12	TJ	20/240 F & C
15"	BR3A-15	BR5A-15	TI	0/250 F & C
18"	BR3A-18	BR5A-18	TM	50/300 F & C
24"	BR3A-24	BR5A-24	TP	50/400 F & C
			TR	50/550 F & C
			TS	150/750 F & C
			TT	200/1000 F & C

All specifications are for reference purposes only. In the interests of continuous product improvement, all specifications are subject to change without notice. Please contact Blue Ribbon Corporation for assistance with your application.



INDUSTRIAL THERMOMETER 9" SCALE ADJUSTABLE ANGLE TYPE



Model BR9A35
(Shown with Brass Thermowell)

MODEL BR9A

FEATURES:

- Two screws permit 180° case rotation and stem positioning in 10° increments, for easy viewing adjustment
- Available in 3.5" and 6" stem lengths
- Blue spirit filled thermometer set inside V-shaped aluminum scale with high-contrast black on white numeric scale for easy reading
- NIST traceable calibration with guaranteed accuracy to ± 1 scale division
- Black enameled die cast aluminum construction with glass front minimizing dirt and dust build up for ranges up to 400 °F (200 °C)
- Optional plastic face
- 1¼–18 UNEF swivel nut connection assembly with tapered bulb chamber for proper well seating
- Available in Straight Form and 90° Back Angle

SPECIFICATIONS:

- Dial: 9" (230mm) aluminum
- Lens: Glass
- Connection: 1¼–18 UNEF swivel nut
3.5" or 6" stem length (see ordering guide)
- Scale: Aluminum painted white with black markings
- Bulb Chamber: Tapered cast aluminum with graphite fill
- Tube, Sensing Liquid: Glass, spirit organic fluid
- Adjustment: Fully adjustable
- Accuracy: $\pm 1\%$
- Enclosure Rating: IP54

INDUSTRIAL THERMOMETER 9" SCALE ADJUSTABLE ANGLE TYPE

DIMENSIONAL DRAWING

All dimensions are in inches (mm)

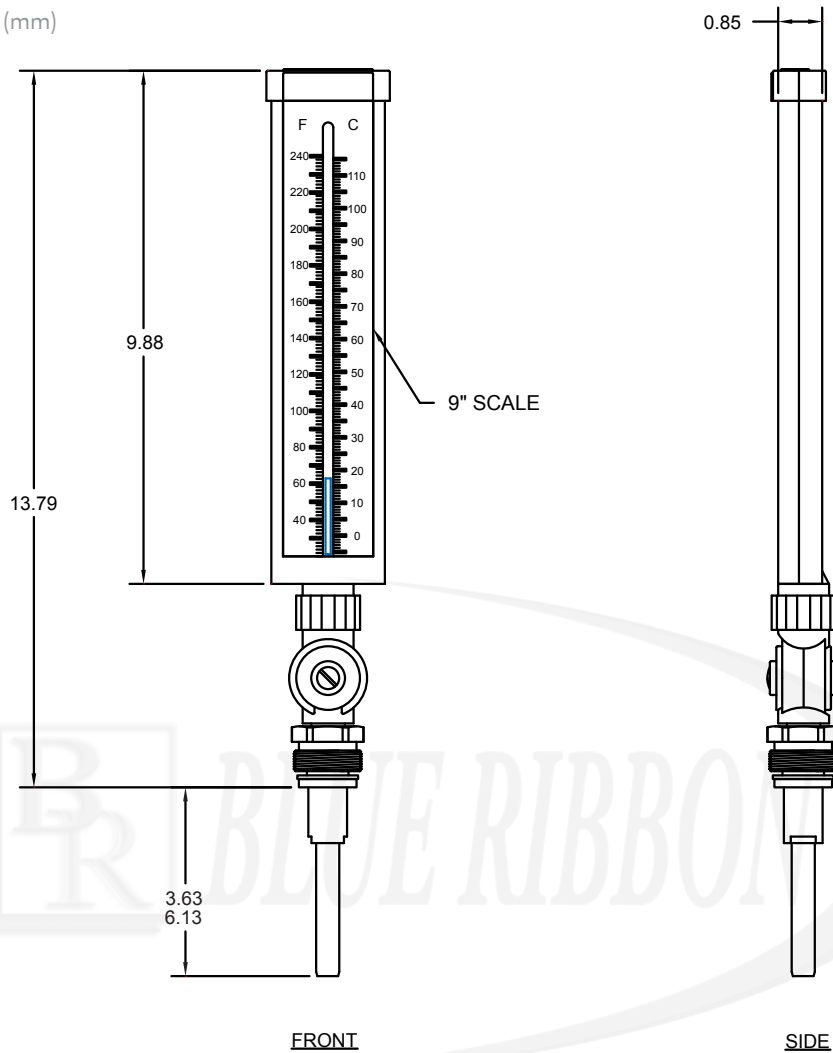

ORDERING GUIDE

Example: BR9A35-240

MODEL	STEM LENGTH	TEMP RANGE
BR9A	35 = 3.5"	110 = -40-110 °F/C
	6 = 6"	120 = 0-120 °F/C
		160 = 30-160 °F/C
		180 = 30-180 °F/C
		240 = 30-240 °F/C
		300 = 30-300 °F/C

All specifications are for reference purposes only. In the interests of continuous product improvement, all specifications are subject to change without notice. Please contact Blue Ribbon Corporation for assistance with your application.



HOT WATER THERMOMETERS

MODELS BRHW5/5A

OVERVIEW:

The BRHW5/5A series thermometers are rugged and economical. Available in both bottom and adjustable angle connections with an easy to read dual scale, they provide an excellent option for a number of heat related applications.

APPLICATIONS:

- Hydronic heating system
- Boiler
- Water line temperature measurement

SPECIFICATIONS:

- 5" Valox case
- Easy-to-read black on white scale
- Blue Liquid Filled (Mercury-free)
- 1/2" NPT Connection
- Separable Brass well
- Bottom and adjustable connection
- Accuracy: ± 1 Scale Division



Models BRHW5/5A

HOT WATER THERMOMETERS

DIMENSIONAL DRAWING

All dimensions are in inches (mm)

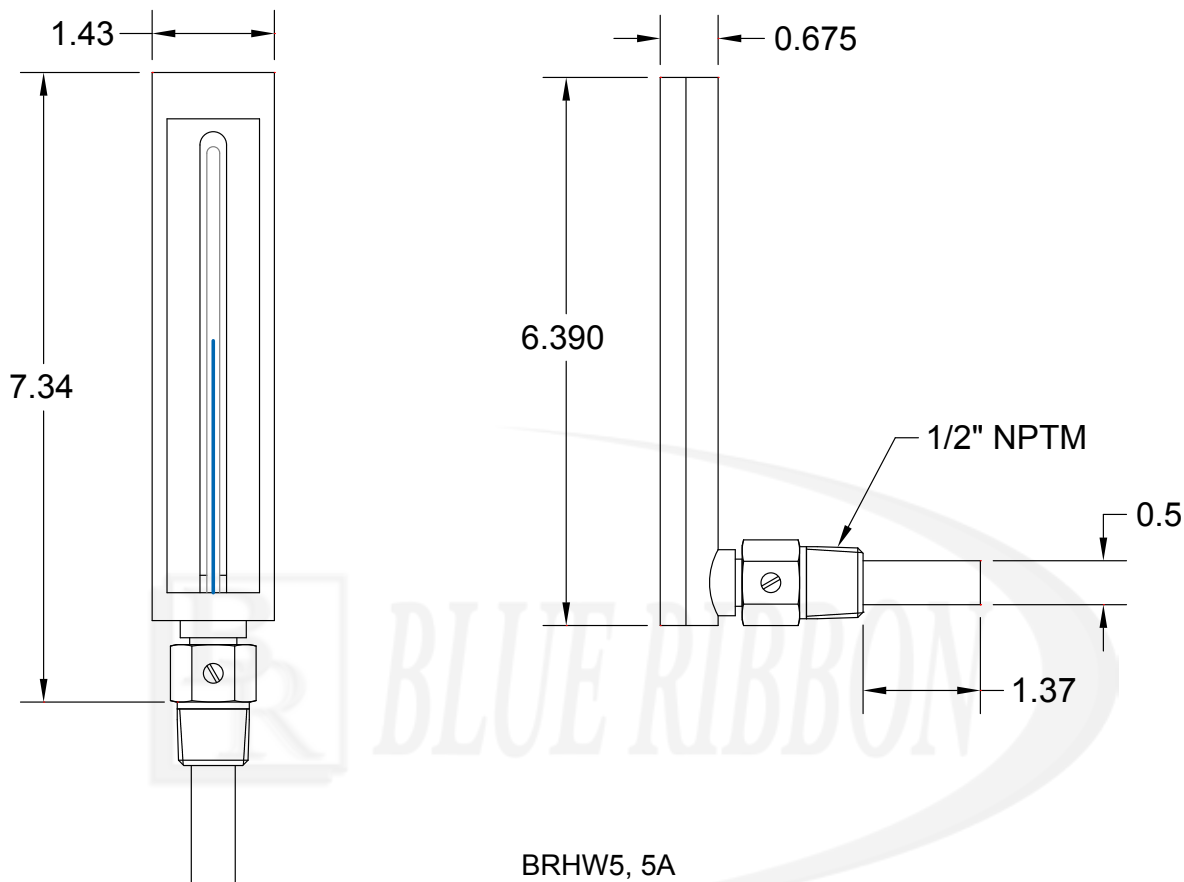

BRHW5, 5A
THERMOMETER

Temp. Range	Straight	Angle
-40 to 110 F/C	BRHW5S	BRHW5A
30 to 240 F/C	BRHW5S-240	BRHW5A-240

All specifications are for reference purposes only. In the interests of continuous product improvement, all specifications are subject to change without notice. Please contact Blue Ribbon Corporation for assistance with your application.



© 2015 Blue Ribbon Corp. | 2770 Long Rd, Grand Island, NY 14072 USA

Order from: **C A Briggs Company**; 622 Mary Street; Suite 101 - Warminster, PA 18974
Phone: 267-673-8117 - Fax: 267-673-8118; E-Mail: Sales@cabriggs.com - www.cabriggs.com



HOT WATER THERMOMETER

MODEL BRHW

FEATURES:

- An economical and accurate means to measure air or water temperatures
- Separable thermowell with optional sweat well
- Bimetallic element
- Dual scale (Fahrenheit & Celsius)
- Easy to install
- 1/2" NPT Connection
- 1 year warranty

SPECIFICATIONS:

- 2.5" dial (63mm), aluminum case
- Glass lens
- 1/2" NPT Connection
- Bi-metallic sensing element
- Recalibrator Standard
- Accuracy: ± 1



Model BRHW
Hot Water Thermometer

Part Number	Temp. Range	Connection
BRHW	30 to 240 °F	1/2" NPT
BRHW-SW	30 to 240 °F	3/4" Sweat Well

HOT WATER THERMOMETERS

DIMENSIONAL DRAWING

All dimensions are in inches (mm)

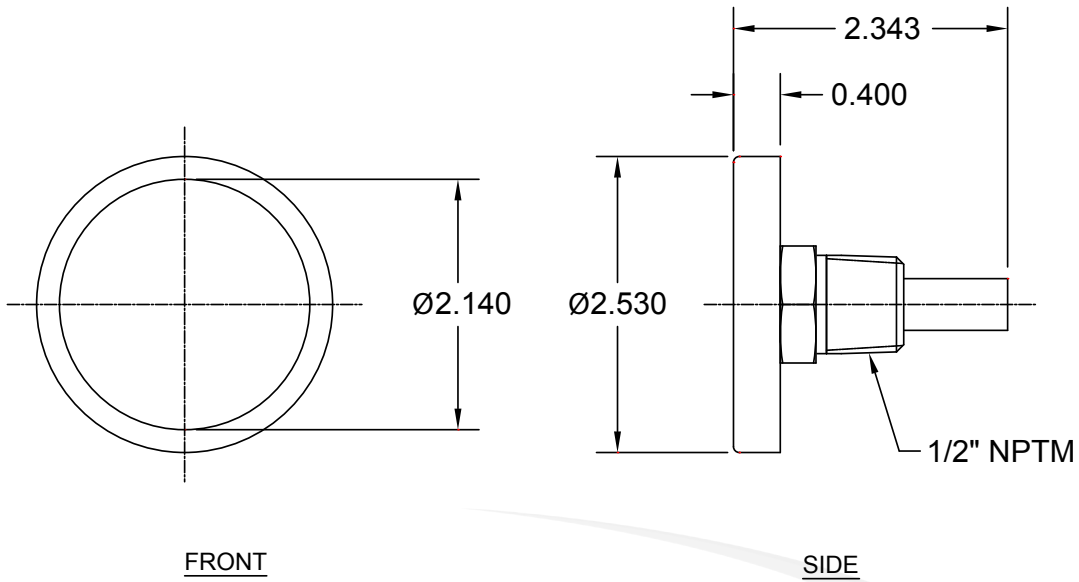

BRHW
2.5" hot water thermometer

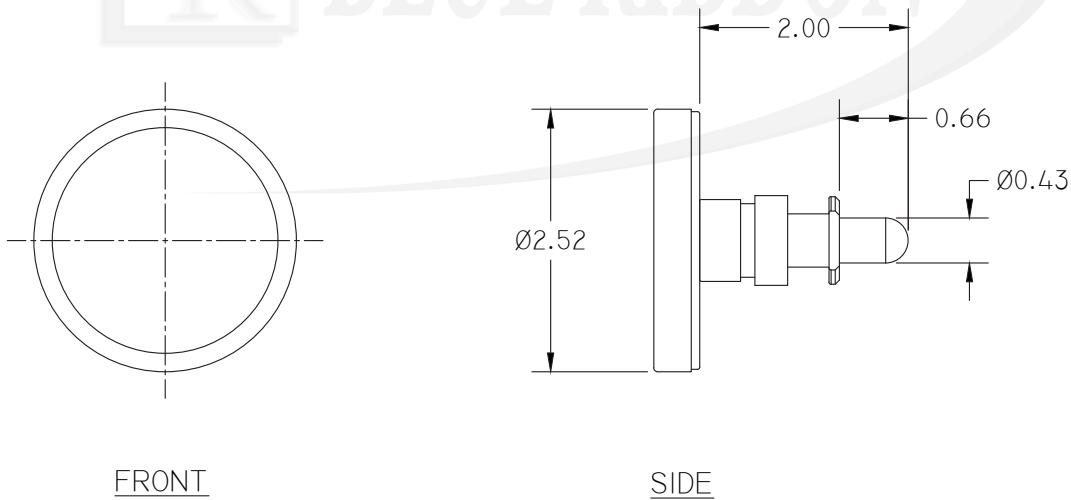

BRHW
2.5 HOT WATER THERM

All specifications are for reference purposes only. In the interests of continuous product improvement, all specifications are subject to change without notice. Please contact Blue Ribbon Corporation for assistance with your application.





CLAMP-ON THERMOMETER

MODEL BRCT

FEATURES:

- Clamp-on design with steel spring
- Dual Scale (°F & °C)
- Easy to install
- Fits pipe sizes to 4" (100mm)

SPECIFICATIONS:

- **Dial:** 2.5" (63mm) aluminum with black markings
- **Case:** Steel
- **Lens:** Plexiglass
- **Ring:** Steel, chrome plated
- **Sensing Element:** Bi-metallic coil
- **Pointer:** Aluminum, painted black
- **Over-Range Enclosure Rating:** 25% of Full-scale value
- **Ambient/Process Temperature:** -40 °F to 390 °F (-40 °C to 200 °C)
- **Accuracy:** ±3% of Full-scale
- **Enclosure Rating:** IP52

APPLICATIONS:

- To measure surface temperature on pipe.



Model BRCT
Clamp-On Thermometer

BRCT CLAMP-ON THERMOMETER

DIMENSIONAL DRAWING

All dimensions are in inches (mm)

BRCT Clamp-On Thermometer

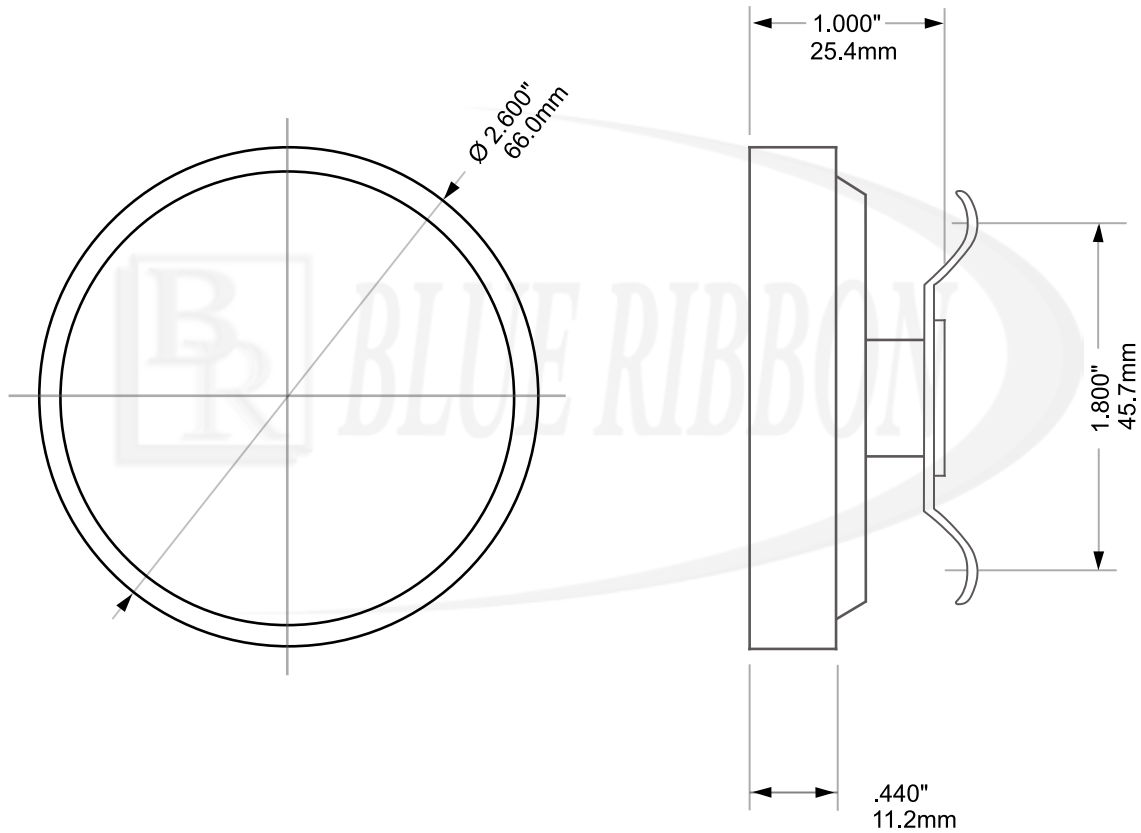

Range	Code
-40 °F to 390 °F & -40 °C to 200 °C	BRCT

All specifications are for reference purposes only. In the interests of continuous product improvement, all specifications are subject to change without notice. Please contact Blue Ribbon Corporation for assistance with your application.

© 2016 Blue Ribbon Corp. | 2770 Long Rd, Grand Island, NY 14072 USA



Order from: **C A Briggs Company**; 622 Mary Street; Suite 101 - Warminster, PA 18974
Phone: 267-673-8117 - Fax: 267-673-8118; E-Mail: Sales@cabriggs.com - www.cabriggs.com

BIMETAL THREADED THERMOWELLS

MODEL BRTW

FEATURES:

Model BRTW bimetal threaded thermowells from Blue Ribbon Corporation are designed to protect the thermometer from possible exposure to process media that may be corrosive or under pressure. Thermowells also facilitate removal of the industrial thermometer without interruption of the process. Their durable design offers high reliability and media compatibility in a range of sizes and materials.

SPECIFICATIONS:

- **Thermometer Connection:**
 - 1/2" NPT female (other thread sizes available upon request)
- **Process Connection:**
 - 3/4", 1/2" or 1" NPT connection (other thread sizes available upon request)
- **Bore:**
 - 0.260" (6.5mm)
- **Construction:**
 - Stepped construction
 - Tapered construction standard
- **Materials:**
 - Brass, AISI 304 stainless steel, AISI 316 stainless steel
 - Other materials available upon request



Model BRTW
Bimetal Threaded Thermowells

ORDERING GUIDE

Example: BR-TW22-4-BRS
Brass Bimetal Thermowell, 3.5" NPT 4" Stem

Model	Connection	Stem Length	Material
BR-TW	22 - 1/2" NPT	2.5 - 2.5"	BRS - Brass
	75 - 3/4" NPT	4 - 4"	304 - 304 SS
		6 - 6"	316 - 316 SS
		9 - 9"	

BIMETAL THREADED THERMOWELLS

DIMENSIONAL DRAWING

All dimensions are in inches (mm)

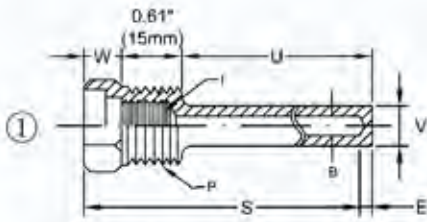

Stem	W	U	S	E	V	B	I	P
2.5"	0.40" (10.16mm)	1.75" (44.45mm)	2.5" (63.50mm)	0.26" (6.60mm)	0.44" (11.18mm)	0.26" (6.60mm)	1/2" NPSM	3/4" NPT

U	Insertion Length
E	Tip Thickness
S	Stem Length
T	Lagging Extension
W	Wrench Allowance
B	Bore Diameter
V	Shank Diameter
P	Process Connection
I	Internal Thread

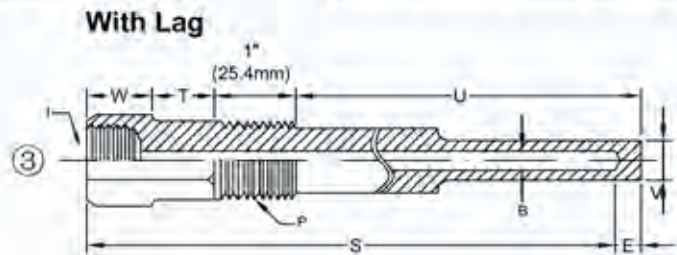
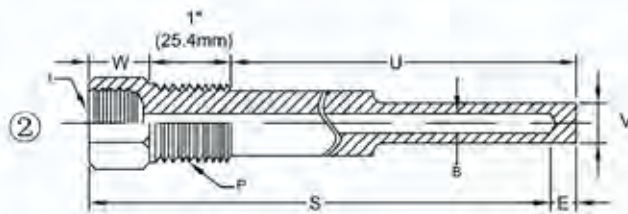

Stem	W	U	U(With Lag)	S	E	V	B	T	I	P
4"	0.75" (19.05mm)	2.50" (63.50mm)	1.90" (48.26mm)	4" (101.60mm)	0.25" (6.35mm)	0.5" (12.70mm)	0.26" (6.60mm)	0.6" (15.24mm)	1/2" NPSM	3/4" NPT
6"	0.75" (19.05mm)	4.50" (114.30mm)	2.50" (63.50mm)	6" (152.40mm)	0.25" (6.35mm)	0.5" (12.70mm)	0.26" (6.60mm)	2" (50.80mm)	1/2" NPSM	3/4" NPT
9"	0.75" (19.05mm)	7.50" (190.50mm)	4.50" (114.30mm)	9" (228.60mm)	0.25" (6.35mm)	0.5" (12.70mm)	0.26" (6.60mm)	3" (76.20mm)	1/2" NPSM	3/4" NPT
12"	0.75" (19.05mm)	10.50" (266.70mm)	7.50" (190.50mm)	12" (304.80mm)	0.25" (6.35mm)	0.5" (12.70mm)	0.26" (6.60mm)	3" (76.20mm)	1/2" NPSM	3/4" NPT
15"	0.75" (19.05mm)	13.50" (342.9mm)	10.50" (266.70mm)	15" (381.00mm)	0.25" (6.35mm)	0.5" (12.70mm)	0.26" (6.60mm)	3" (76.20mm)	1/2" NPSM	3/4" NPT
18"	0.75" (19.05mm)	16.5" (419.1mm)	13.50" (342.9mm)	18" (457.20mm)	0.25" (6.35mm)	0.5" (12.70mm)	0.26" (6.60mm)	3" (76.20mm)	1/2" NPSM	3/4" NPT
24"	0.75" (19.05mm)	22.5" (571.5mm)	19.50" (495.30mm)	24" (609.60mm)	0.25" (6.35mm)	0.5" (12.70mm)	0.26" (6.60mm)	3" (76.20mm)	1/2" NPSM	3/4" NPT

All specifications are for reference purposes only. In the interests of continuous product improvement, all specifications are subject to change without notice. Please contact Blue Ribbon Corporation for assistance with your application.





INDUSTRIAL THREADED THERMOWELLS

MODEL BR9TW

FEATURES:

- Designed for use with all 9" (228mm) Industrial thermometers.
- Allows for easy replacement of thermometer without interruption of the industrial process.
- Protects thermometer from exposure to the process media.
- 1-year warranty

SPECIFICATIONS:

- **Thermometer Connection:**
 - 1/2" NPT female (other thread sizes available upon request)
- **Process Connection:**
 - 3/4", 1/2" NPT standard, optional thread sizes available
- **Bore:**
 - 0.467" (11.9mm)
- **Construction:**
 - Stepped construction
 - Tapered construction standard
- **Materials:**
 - Brass, AISI 304 stainless steel, AISI 316 stainless steel
 - Other materials available upon request



Model BR9TW
Industrial Threaded Thermowells

ORDERING GUIDE

Example: BR9TW-B-35
Brass Thermowell with 3.5" Stem

Model	Material	Stem Length	Lagging
BR9TW	B-Brass	35-3.5"	1-1"
	LFB - Lead Free Brass	6-6"	25-2.5"
	SS - 304 Stainless Steel		



INDUSTRIAL THREADED THERMOWELLS

DIMENSIONAL DRAWING

All dimensions are in inches (mm)

3.5" Stem without Lag

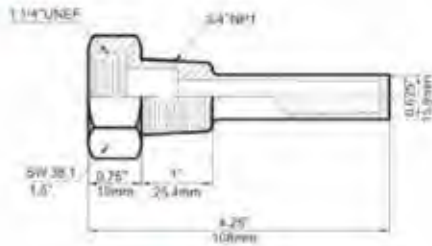

3.5" Stem with Lag

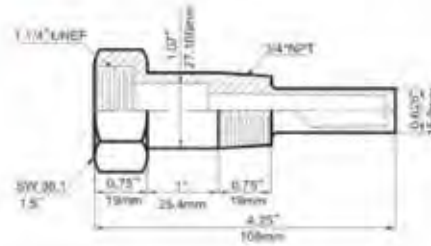

6" Stem without lag

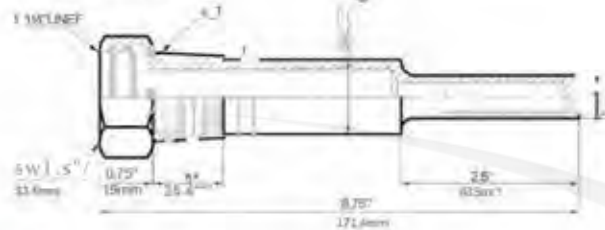

6" Stem with lag

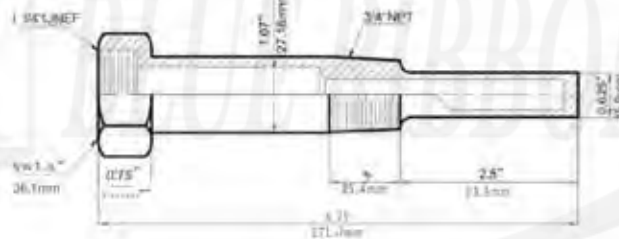

Stem	W	U	U(With Lag)	S	E	V	B	T	I	P
3.5"	0.75" (19.05mm)	2.50" (63.50mm)	1.50" (38.10mm)	3.5" (88.90mm)	0.16" (4.06mm)	0.62" (15.75mm)	0.44" (11.18mm)	1.00" (25.40mm)	1 1/4"-18 UNEF	3/4" NPT
6"	0.75" (19.05mm)	5.00" (127.00mm)	2.50" (63.50mm)	6" (152.40mm)	0.16" (4.06mm)	0.62" (15.75mm)	0.44" (11.18mm)	2.5" (63.50mm)	1 1/4"-18 UNEF	3/4" NPT
8"	0.75" (19.05mm)	7.00" (177.80mm)	4.50" (114.30mm)	8" (203.20mm)	0.16" (4.06mm)	0.62" (15.75mm)	0.44" (11.18mm)	2.5" (63.50mm)	1 1/4"-18 UNEF	3/4" NPT
12"	0.75" (19.05mm)	11.00" (279.40mm)	5.00" (203.20mm)	12" (304.80mm)	0.16" (4.06mm)	0.62" (15.75mm)	0.44" (11.18mm)	3" (76.20mm)	1 1/4"-18 UNEF	1" NPT
18"	0.75" (19.05mm)	17.00" (431.80mm)	14.00" (355.60mm)	18" (457.20mm)	0.16" (4.06mm)	0.62" (15.75mm)	0.44" (11.18mm)	3" (76.20mm)	1 1/4"-18 UNEF	1" NPT

All specifications are for reference purposes only. In the interests of continuous product improvement, all specifications are subject to change without notice. Please contact Blue Ribbon Corporation for assistance with your application.